

# Vertical Fixing Guide for Tiles and Stone

## Packaging



## Mixing



## Application



## Uses

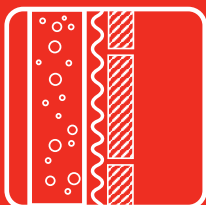

Adhesive Fix

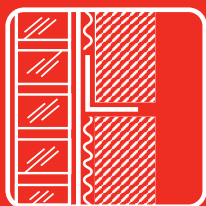

Pin or Bracket Fix

## Substrates

External  
Concrete  
Cement Render  
Masonry, Brick,  
Block

Internal  
Building Boards  
Cement/Gypsum

## Substrate load bearing capacity

Concrete	60kg/m <sup>2</sup>
*Cement render	32kg/m <sup>2</sup>
Masonry, brick, block	32kg/m <sup>2</sup>

\*Cement render to be polymer-modified and be bonded to the substrate with **Primax**.

### Building boards (manufacturer approved)

Used and fixed in accordance with the manufacturer's instructions and waterproofed with **Epecrete** or **Liquid Flash 2** if required.

- Gypsum (internal use only)
  - Cement sheet (internal and external use)
- |                        |                     |
|------------------------|---------------------|
| Fixed at 100mm centres | 32kg/m <sup>2</sup> |
| Fixed at 200mm centres | 15kg/m <sup>2</sup> |
- Substrate loads must not be exceeded.**

## Fixing Guide

When fixing tiles above 3m a risk assessment based on OH&S principles should be done and mechanical supports considered, particularly in the case of large format tiles or heavy stone tiles.

### Do not tile over horizontal or vertical relief/control joints.

If required, consult a structural engineer, as these matters are outside our scope. Professionals in this field must be consulted on building movement control joints and on pin and bracket requirements.

It is the applicator's sole responsibility to ensure that the following are done perfectly:

- Surface preparation.
- Adhesive application.
- Bedding of the tile/stone with 100% coverage at application and during adhesive cure.

## Application

- The vertical fixing of ceramic tiles and stone **over 3m must only be done by experienced stone or tiling professionals** in accordance with AS3958 and good trade practices.
- Use **Primax** as a primer and **Elastacrete mixed with Kemgrip Floor & Wall or Ultima** as the adhesive, used in accordance with the application directions.
- **Butter the back of the tile and apply the adhesive with a notched trowel appropriate to the size of the tile. Refer to AS3958 or use a 15mm notch trowel. Apply adhesive to the primed substrate to achieve full coverage (100%) of the adhesive to the tile and substrate. Peg or support the tile during installation and curing or allow each row of tiles to cure before fixing the next row.**

## Precautions

- Use the wet weight of the tile or stone when calculating load bearing.
- When applying render to level the substrate, allow a weight of 20kg/m<sup>2</sup> for 12mm thick render.
- Ensure the back of the tile/stone is not contaminated.

**It is the fixer's sole responsibility to check the suitability of the system for the specific purpose.**