

Tiling on Waterproof Membranes

Flexible Sealer Hydrathane Liquid Flash 1

Packaging Mixing



Application



Liquid Flash 2

Packaging Mixing



Application



Adhering Tiles

Packaging Mixing



Application



Substrates

Gypsum
Plasterboard
Cement sheet
Concrete,
Brick, Block
Cement render

Bathrooms, kitchens, laundries, flat roofs, balconies

Tests conducted on direct adhesive fixing of ceramic tiles to the following membranes result in adhesion failing the requirements of AS ISO 13007.1 in the short or long term.

- Urethane or solvent-based polyurethane
- Polyester resin (fibreglass)
- Butanol
- Torch on or hot melt membranes
- Epoxy resin membranes
- Bitumen and bitumen compound

Construction Chemicals therefore does not guarantee direct fixing adhesives to these membranes.

Construction Chemicals manufactures membranes compatible with ceramic tile adhesives (listed below) where the adhesion performance exceed the requirements of the standards. The membrane and the adhesive are compatible and the system is guaranteed.

Waterproof Membranes

Product	Description
Flexible Sealer	Premixed, acrylic, waterproof membrane
Hydrathane	Premixed, water-based, polyurethane membrane
Liquid Flash 1	Premixed, fibre-reinforced, acrylic membrane
Liquid Flash 2	Two-pack, fast-setting, acrylic, reinforced membrane

Ceramic Tile Adhesives

Product	Description
Kemgrip Floor & Wall mixed with Elastacrete	Cement-based adhesive mixed with a flexible resin additive
Monoflex	Polymer-modified, rubber/cement-based adhesive
Gripflex	White, polymer-modified, cement-based adhesive
Kemflex	Two-pack, flexible, cement/rubber adhesive
Drymastic	One-pack, polymer-modified, cement-based adhesive
Acoustibond	Water-resistant, soundproofing ceramic, porcelain and stone tile adhesive

Waterproofing an enclosed shower

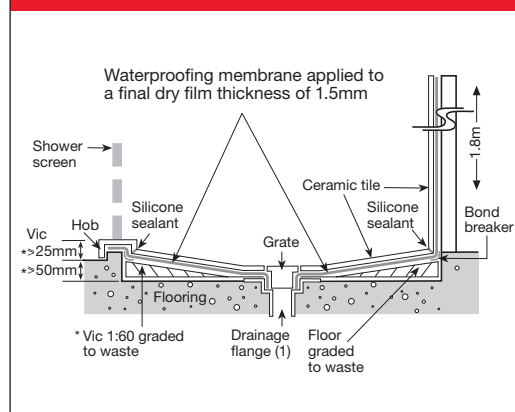

Waterproofing wet area floors - bathrooms and laundries etc.

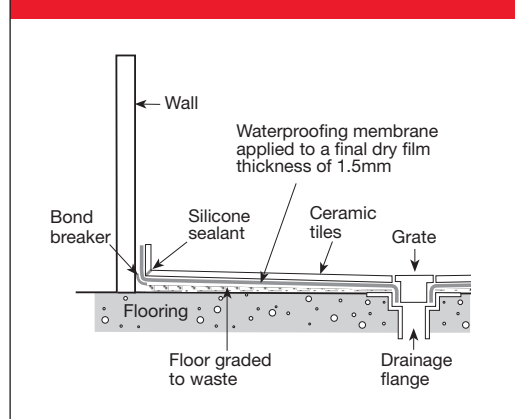

Waterproofing flat roofs and balconies

