

Driband Joint Sealing Tape

Packaging

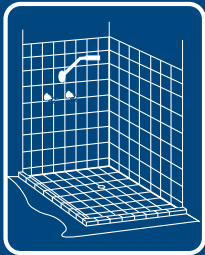

Uses



Substrates

Concrete,
Wet area board,
Brick, Block,
Render,
Metal roofing,
Cement sheet

Waterproof and seal joints, junctions and general areas on floors and walls.

System Components

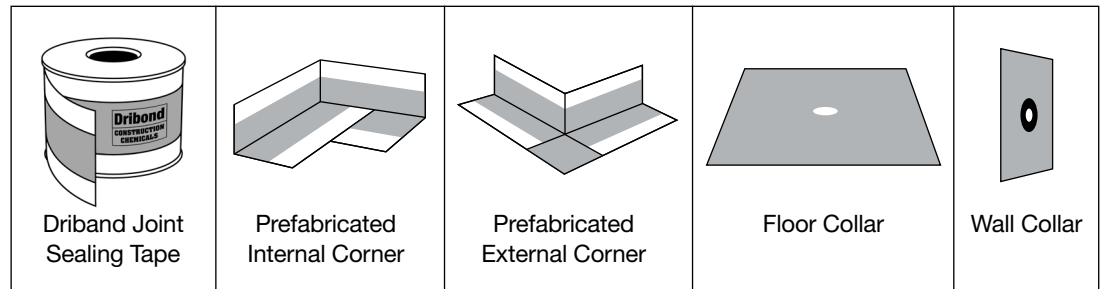

Description

Driband Joint Sealing Tape is made of felt and TPE (thermoplastic elastomer) and is used in conjunction with **Dribond Construction Chemicals** waterproofing membranes to form waterproof seals in joints, junctions and general areas on wet floors and walls which are the most critical points subject to movement.

Uses

- Used as a bond breaker for waterproofing membrane.
- Applications in wet environments, such as pools, water tanks, bathrooms, toilets, laundries and balconies.
- Pipe inlet-outlet application details.
- Isolate static cracks.
- Expansion joints on concrete roofs.

Features

- Easy installation
- High elasticity
- 100% waterproof
- Resistant to many chemicals
- High performance in a wide range of temperatures (-40 to 90°C)



Driband Joint Sealing Tape

Application of prefabricated corners

1. Apply a generous even coat of **Dribond Construction Chemicals** waterproofing membrane into the corner area.

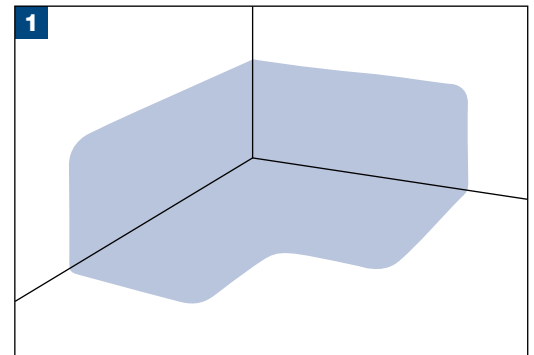

2. Place corner profile into the wet membrane, ensuring full coverage of the felt backing into the membrane film. Use a flat spatula or brush to eliminate any creases or air pockets behind the fabric edges. It is crucial to bed the corner into a wet film of the membrane and prevent it from drying or skinning before positioning. Any excess can be removed by brushing onto the surface or over the face of the corner.

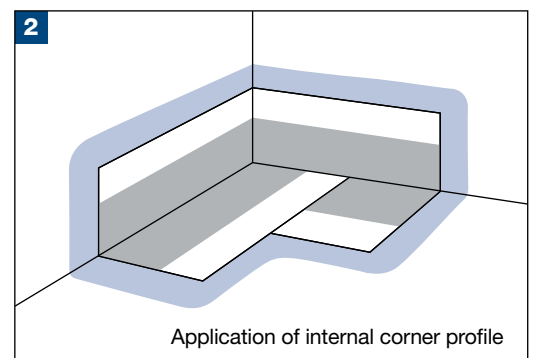

3. Cut and size the joint sealing tape to fit all floor/wall junctions, allowing a minimum 50mm overlap to the sealing corner. Begin by applying a coat of membrane covering approximately 150mm onto floor/walls and minimum 60mm over sealing corners. Place joint sealing tape into the wet membrane ensuring full coverage of the felt backing into the membrane film. Use a flat spatula or brush to eliminate any creases or air pockets behind the fabric edges. It is crucial to bed the sealing tape into a wet film of the membrane and prevent it from drying or skinning before positioning. Any excess can be removed by brushing onto the surface or over the face of the tape.

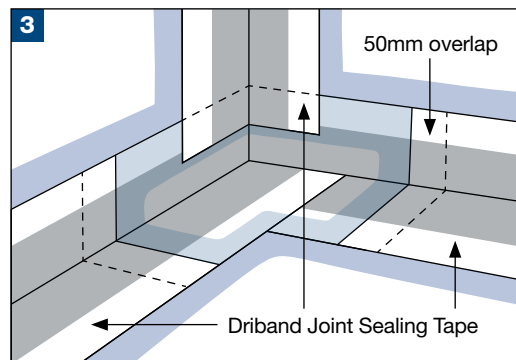

4. The remaining joints can be sealed according to the above directions. Standard waterproofing procedures in accordance with AS3740 can commence at this time.

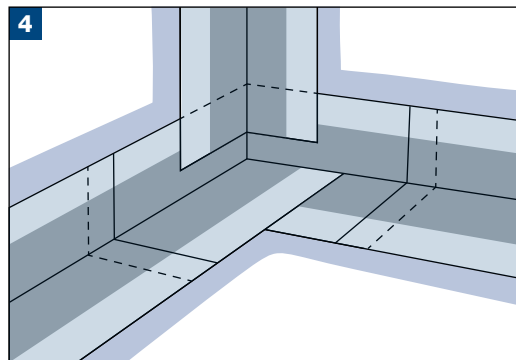

If prefabricated corners are not used, the sealing tape must be cut and folded, ensuring the fabric is fully bonded with **Dribond Construction Chemicals** membrane.

Dribond Collars

Application of Dribond Collars

Dribond Collars can be used for sealing around penetrations, such as pipes and drainage outlets.

1. Measure the diameter of the pipe or penetration to be sealed.
2. Select appropriate **Dribond Collar** and cut hole (if necessary) to suit.
3. Apply a generous, even coat of **Dribond Construction Chemicals** waterproofing membrane onto the surface around the penetration to be sealed, ensuring full coverage of the felt backing into the membrane film can be achieved.
4. Slide collar over pipe/penetration, ensuring full coverage of the felt backing into the membrane film. Use a flat spatula or brush to eliminate any creases or air pockets behind the fabric edges. It is crucial to bed the sealing tape into a wet film of the membrane and prevent it from drying or skinning before positioning. Any excess can be removed by brushing onto the surface or over the face of the collar.

Standard waterproofing procedures in accordance with AS3740 can commence at this time.

Precautions

- Incompatible with solvent-based substances, such as adhesives, sealants or coatings.
- Avoid use as a UV-exposed joint seal in external applications.
- Do not apply when surface temperature is below 5°C or exceeds 35°C.
- For additional information, contact the **Dribond Construction Chemicals** technical department.

Specifications

Hardness (shore A) - ISO868	65
Tensile strength (Mpa) - ISO37	4.20
Elongation at break (%) - ISO37	600
Max. dynamic service temperature (°C)	90
Colour	Grey
Water resistance	Very good
Alcohol resistance	Very good
Olive oil resistance	Suitable
Sulfuric acid resistance	Good
Detergent resistance	Good
Chemical formulation	TPE & felt
System width (mm)	120
Working temperature (°C)	-40/+90
Thickness (mm)	0.6
Strength of water pressure (bar)	1.5



www.constructionchemicals.com.au

The information contained in this technical publication is based on our current knowledge and experience and is provided as a guide only. In view of the many factors that may affect application it is the user's sole responsibility to ensure suitability for a specific purpose. Always refer to the most recent technical datasheet for the product concerned at: www.constructionchemicals.com.au

Adelaide (08) 8243 7888 **Sydney** (02) 9756 3533
Brisbane (07) 3271 2944 **Auckland** (09) 273 5444
Melbourne (03) 9761 4711 **Kuala Lumpur** (603) 5122 2522
Perth (08) 9356 9999